

Suspension Leverage Ratio

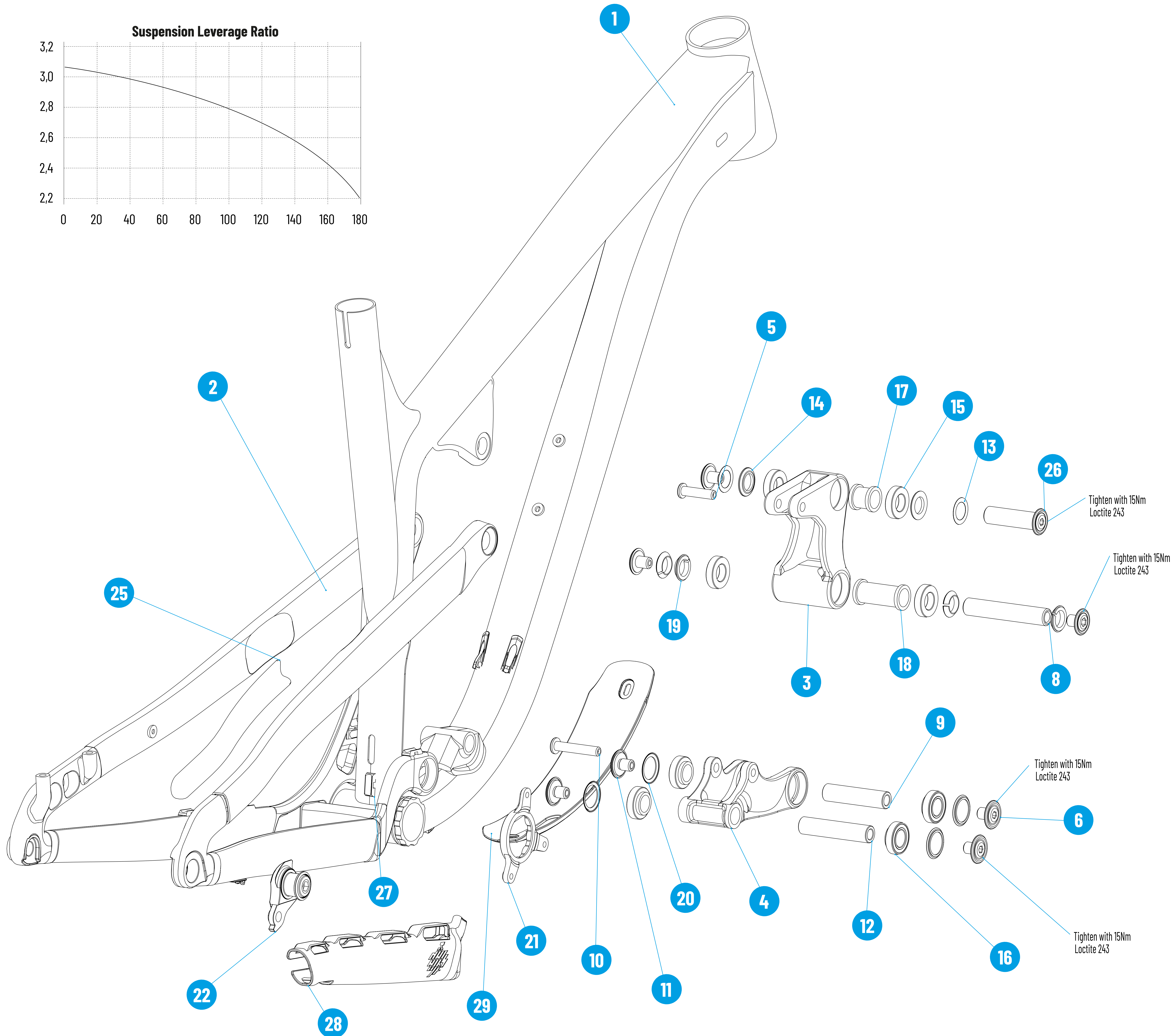
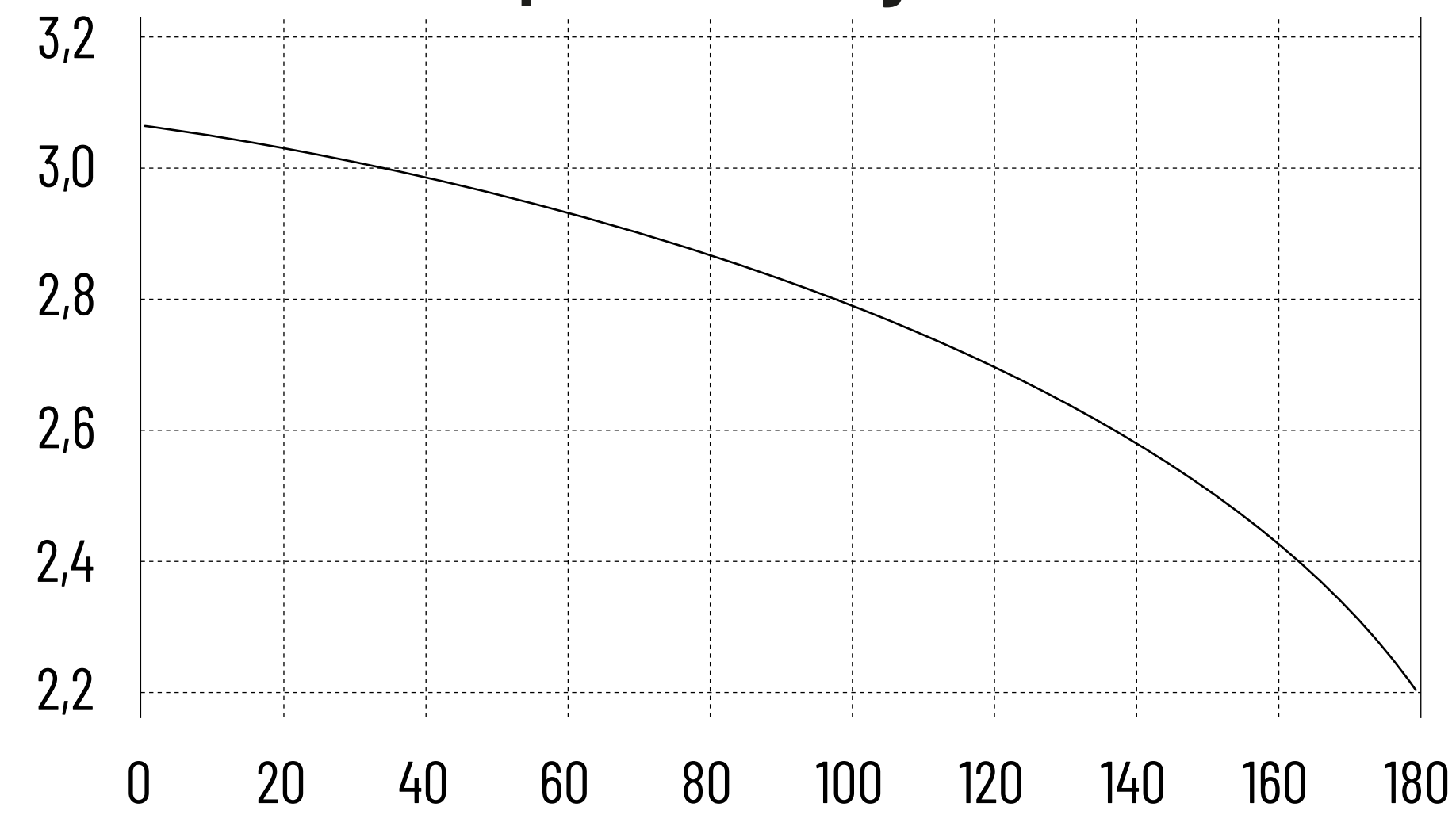

NO	Propain Part number/revision	Description	QTY.
1	001265-AD	front triangle spindrift alu 29 (L)	1
2	001176-AF	Rear_triangle_Spindrift	1
3	001288-AA	top rocker	1
4	001044-AB	Lever_low	1
5	001287-AA	Bolt_M8x32_custom	1
6	000605-AB	15mm_clamp_Axle_Cap	3
8	001066-AA	Axle_15x91xM10_clamp_type	1
9	000616-AA	Axle_15dia_62mm_M10x1	1
10	000992-AA	Bolt_M8x48_custom	1
11	000600-AB	15mm_Axle_Cap	4
12	001115-AA	Axle_15dia_69-5mm_M10x1	1
13	001293-AA	spacer 15x0.25	2
14	001294-AA	washer 15x2.5	2
15	000006-AA	Bearing_15x28x7	4
16	000176-AA	Bearing_15x28x7_flange	4
17	001295-AA	Spacer 20x16	1
18	001296-AA	Spacer 45.5x16	1
19	000604-AA	Clamp_ring_15mm_axle	4
20	000602-AB	Dust_cap_seal	4
21	001076-AC	ISCG_05_removable_boost148	1
22	001201-AA	Sram UDH Hanger	1
25	001188-AA	SS_protector_Tyee_alloy	1
26	001299-AA	15mm_Axle_Top_Pivot	1
28	001316-AA	Chain_stay_protector_Spindrift_CF	1
29	001314-AA	DT_protector_Spindrift_Alu_2020	1

SPINDRIFT AL - Standards

Shock length	230mm
Shock travel	65mm
Shock mount top	8mm x 20
Shock mount bottom	8mm x 30
Rear wheel travel	180mm
Bottom bracket	BSA 73mm
Brake mount Post mount	180
Seat post diameter	31,6mm
Head set (S.H.I.S.)	Top: ZS49 / Bottom: ZS56
Rear wheel axle	X12 axle for UDH Hanger
Rear hub width	148mm (Boost)
Chain line	52 mm (boost)
Chain guide mount	ISCG 05
Tire size	27,5" / 29 "
Maxium fork travel	190mm

Tighten with 15Nm
Loctite 243

Tighten with 15Nm
Loctite 243

Tighten with 15Nm
Loctite 243

Tighten with 15Nm
Loctite 243